

LINE 5

CONDOS AT YONGE & EGLINTON

**NEW EXCLUSIVE 2024 INCENTIVES**  
**CARRYING COSTS SAVINGS PROGRAM**





CONDOS AT YONGE & EGLINTON

## **NEW EXCLUSIVE 2024 INCENTIVES** **CARRYING COSTS SAVINGS PROGRAM**

**RECEIVE A CREDIT ON CLOSING OF UP TO \$133,200 \***

**+**

### **Special Deposit Program \*\***

\$50,000 – Studio and 1 Bedroom and 1 Bedroom + Den Suites

\$60,000 - 2 Bedroom Suites

\$70,000 – 3 Bedroom Suites

Balance to 15% at Occupancy

### **FREE ASSIGNMENT\*\*\***

### **RIGHT TO LEASE DURING OCCUPANCY**

### **CAPPED DEVELOPMENT & EDUCATIONAL CHARGES**

- \$10,900 for Studio Suites
- \$11,900 for 1 Bedroom and 1 Bedroom + Den Suites
- \$12,900 for 2 Bedroom, 2 Bedroom + Den/Media, 3 Bedroom Suites

*Must Comply with the Prohibition on the Purchase of Residential Property by Non-Canadians Act*

*\* A credit on account of the Purchase Price as an Adjustment on the Statement of Adjustments for the closing on the Unit Transfer Date. The credit amount varies by suite selection. Please speak to our Sales Representatives for further details on incentives and credits.*

*\*\* \$10,000 on Signing, \$20,000 in 30 days, \$20,000 in 180 days for Studios and 1B/1B+D, \$30,000 in 180 days for 2B, \$40,000 in 180 days for 3B. Balance to 15% at Occupancy.*

*\*\*\*Legal fees will apply.*

*Please speak to a Sales Representative for details.*

*This Carrying Costs Savings Program applies to select suites and is a limited time offer.*

*Please speak to a Sales Representative for details. Restrictions may apply. This Carrying Costs Savings Program applies to select suites and is a limited time offer. Prices, Incentives and specifications are subject to change without notice E. & O.E.*

*June 1, 2024*



CONDOS AT YONGE & EGLINTON

## NEW EXCLUSIVE 2024 INCENTIVES CARRYING COSTS SAVINGS PROGRAM

### NORTH TOWER

MODEL	TYPE	APPROX. SIZE	EXP.	OUTDOOR SIZE	FLOOR	SUITE PRICE	CREDIT*
T-03	Studio/1b	347	W	55	36	\$599,900	\$131,450
T-01	1B/1b	493	S	Even – 132 Odd – 80	35	\$782,900	\$117,350
T-12	1B/1b	538	S	102	35	\$857,900	\$131,600
T-05	2B/2b	628	N	79	35	\$973,900	\$126,100
T-06	2B/2b	628	N	95	35	\$975,900	\$128,100
T-07	2B/2b	628	N	Even – 116 Odd – 77	34	\$979,900	\$132,100

### SOUTH TOWER

MODEL	TYPE	APPROX. SIZE	EXP.	OUTDOOR SIZE	FLOOR	SUITE PRICE	CREDIT*
T-03	Studio/1b	353	W	55	31	\$599,900	\$123,350
T-07	1B/1b	482	N	Even – 68 Odd – 96	30	\$775,900	\$125,200
T-08	1B+D/1b	514	N	76	33	\$814,900	\$121,000

#### NEW EXCLUSIVE SPRING 2024 INCENTIVES CARRYING COSTS SAVINGS PROGRAM

##### SPECIAL DEPOSIT PROGRAM

\$10,000 on Signing  
 \$20,000 in 30 days  
 \$20,000 in 180 days for Studios and 1B/1B+D  
 \$30,000 in 180 days for 2B  
 \$40,000 in 180 days for 3B  
 Balance to 15% at Occupancy

*Must comply with the Prohibition on the Purchase of Residential Property by Non-Canadians Act.*

##### Parking: Waitlist only

Restrictions apply. Please see a Sales Representative for details.

##### Storage Locker: \$12,500

Restrictions apply. Please see a Sales Representative for details.

##### Maintenance Fees

Approximately \$0.58/sq.ft.  
 Water and hydro are separately metered. Gas is included.

##### Taxes

Estimated at approximately 1% of Purchase Price

*Prices Include H.S.T, as per the Agreement of Purchase and Sale.*

##### Occupancy Commencing:

March 28, 2025

\* Please see a Sales Representative for details.  
 All prices, figures and materials are preliminary and are subject to change without notice E. & O. E. All areas and stated room dimensions are approximate only and are calculated in accordance with the HCRA Directive regarding Floor Area Calculations. All Purchasers must meet the eligibility requirements as set out in the Prohibition on the Purchase of Residential Property by Non-Canadians Act.  
 June 1, 2024



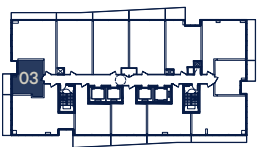
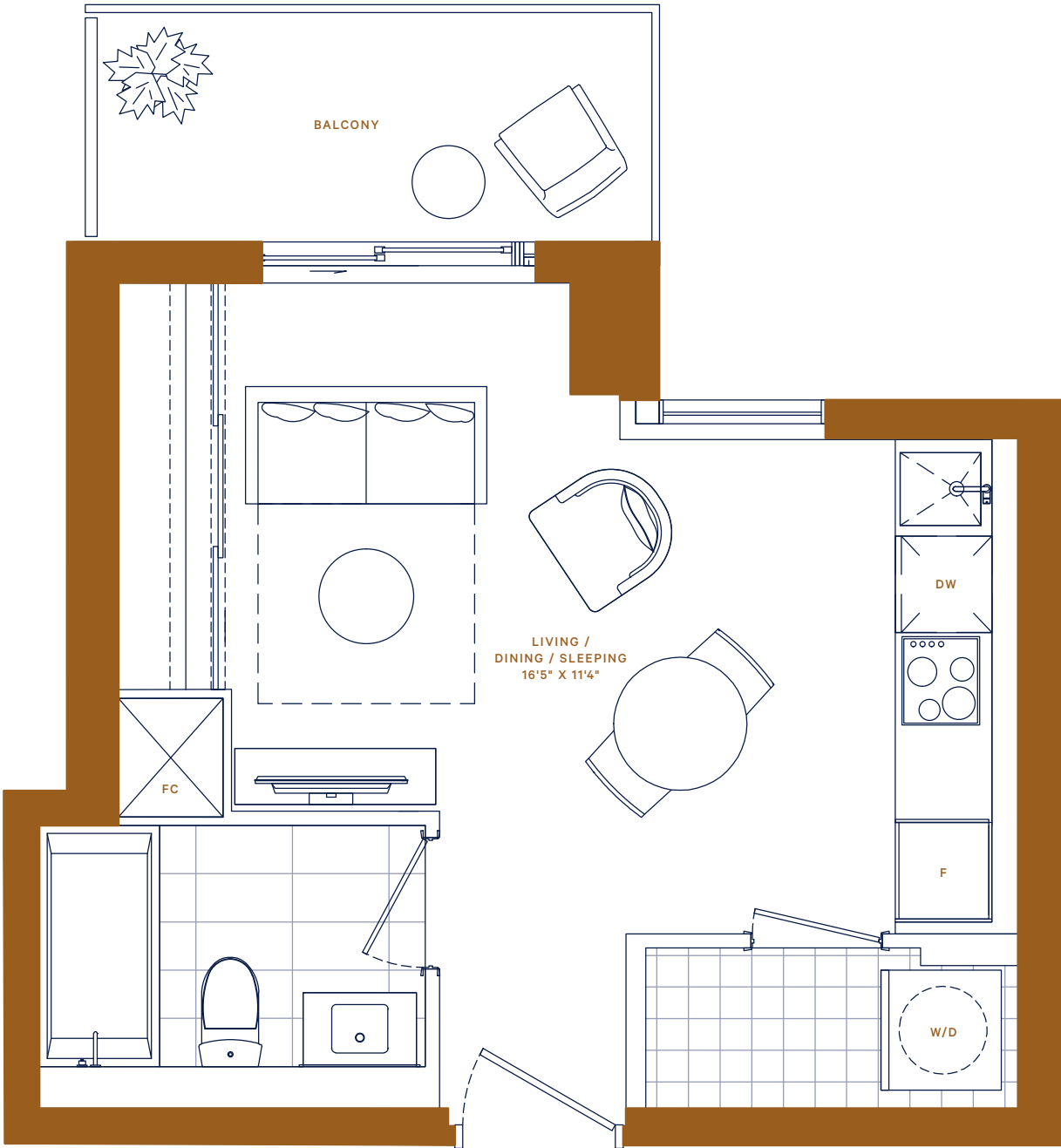

FLOORS 10-36



Dimensions, specifications, layouts and materials are approximate only and are subject to change without notice. Window sizes and locations may vary. Furniture is for illustration purposes only and does not necessarily reflect the electrical plan for the suite. Suites are sold unfurnished. Actual useable floor space within the unit may be different from stated floor areas or dimensions on this plan. For more information on the method used for calculating the floor area of any unit, please refer to Builder Bulletin No. 22 published by Tarion. Balcony and terrace area is approximate and not included in net suite area. The actual unit purchased may be a reverse layout to the plan shown. E.&O.E.

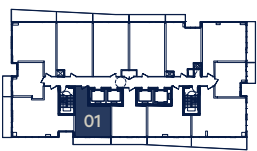
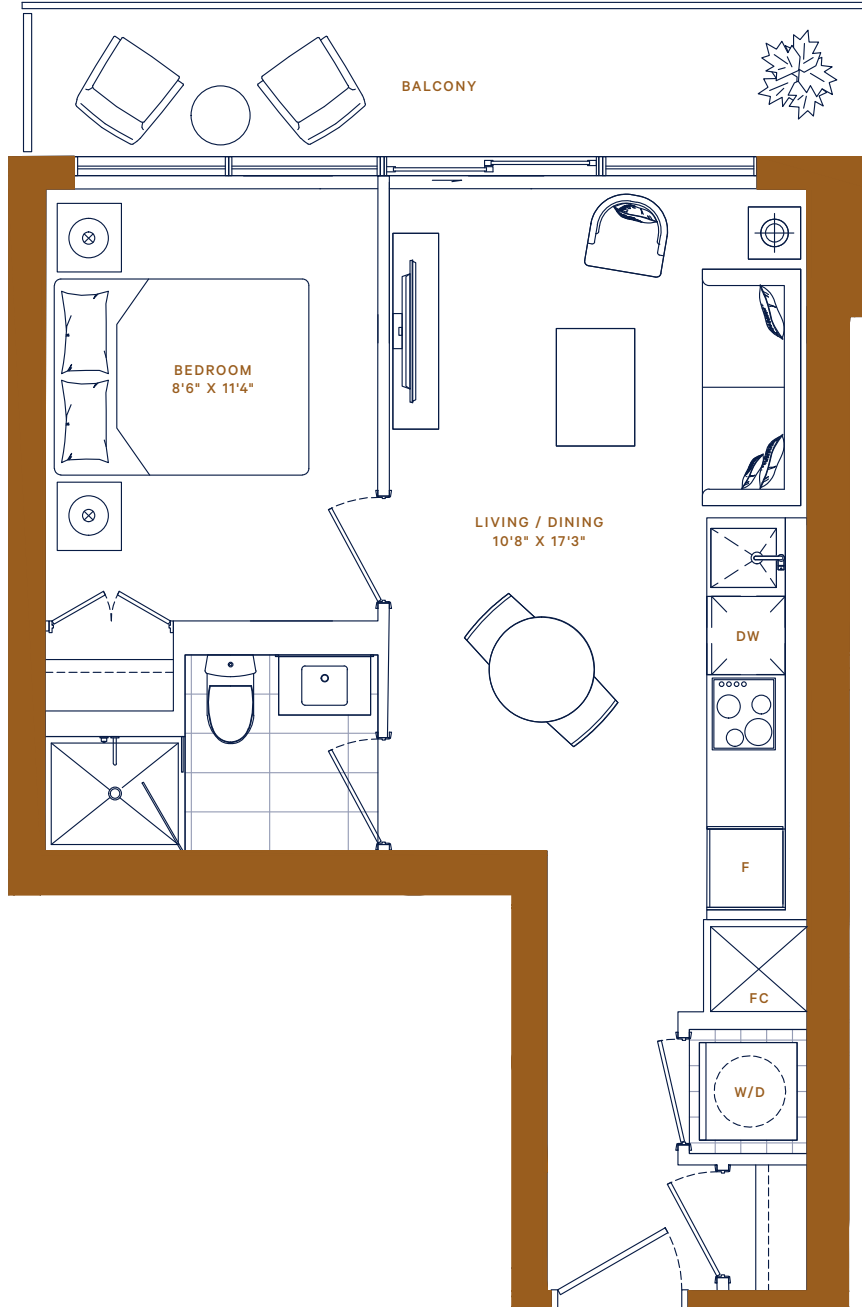

ODD FLOORS 11-35



Dimensions, specifications, layouts and materials are approximate only and are subject to change without notice. Window sizes and locations may vary. Furniture is for illustration purposes only and does not necessarily reflect the electrical plan for the suite. Suites are sold unfurnished. Actual useable floor space within the unit may be different from stated floor areas or dimensions on this plan. For more information on the method used for calculating the floor area of any unit, please refer to Builder Bulletin No. 22 published by Tarion. Balcony and terrace area is approximate and not included in net suite area. The actual unit purchased may be a reverse layout to the plan shown. E.&O.E.

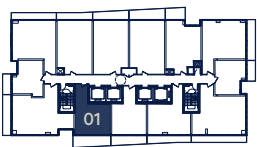
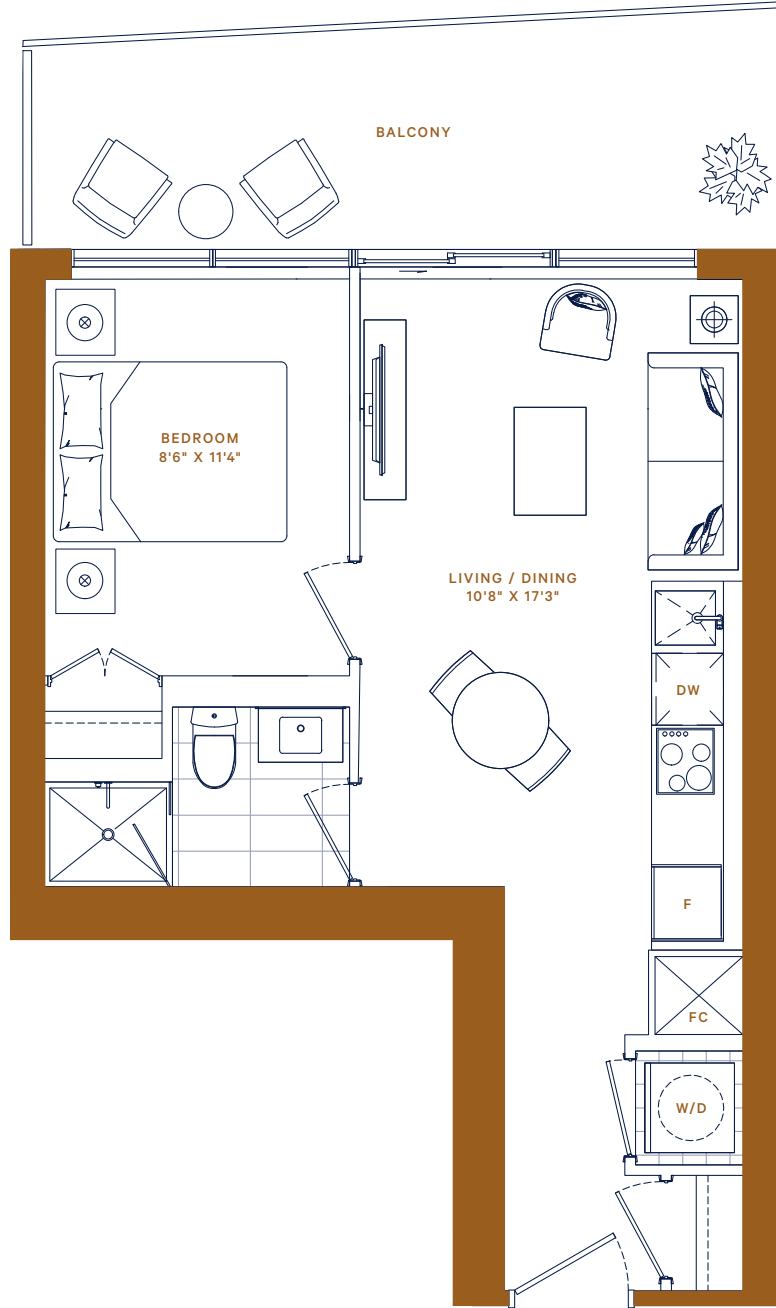

EVEN FLOORS 10-36



Dimensions, specifications, layouts and materials are approximate only and are subject to change without notice. Window sizes and locations may vary. Furniture is for illustration purposes only and does not necessarily reflect the electrical plan for the suite. Suites are sold unfurnished. Actual useable floor space within the unit may be different from stated floor areas or dimensions on this plan. For more information on the method used for calculating the floor area of any unit, please refer to Builder Bulletin No. 22 published by Tarion. Balcony and terrace area is approximate and not included in net suite area. The actual unit purchased may be a reverse layout to the plan shown. E.&O.E.

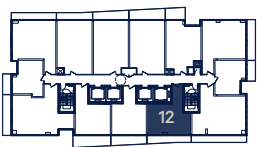
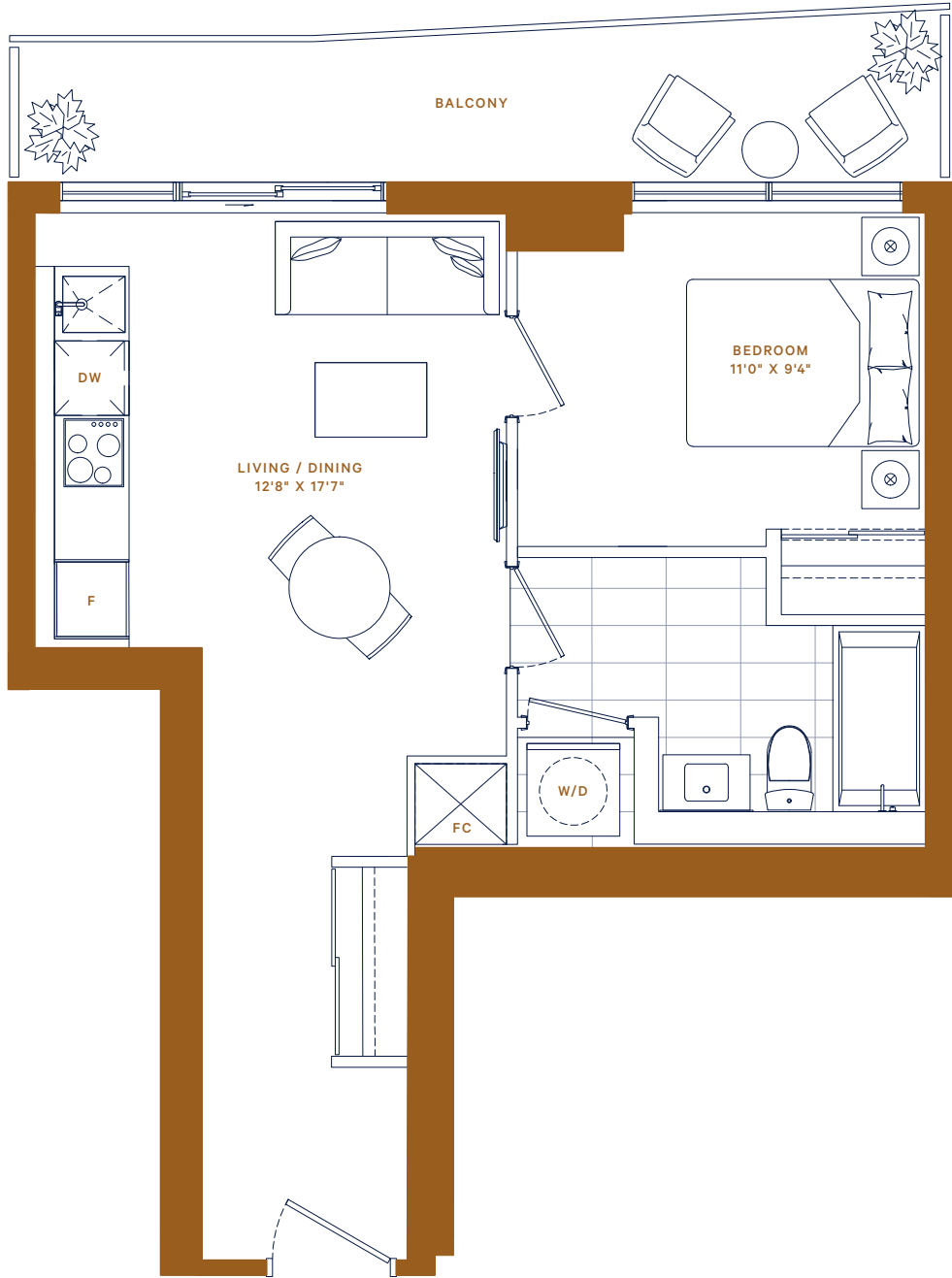

FLOORS 10-36  
BALCONY SIZES MAY VARY



Dimensions, specifications, layouts and materials are approximate only and are subject to change without notice. Window sizes and locations may vary. Furniture is for illustration purposes only and does not necessarily reflect the electrical plan for the suite. Suites are sold unfurnished. Actual useable floor space within the unit may be different from stated floor areas or dimensions on this plan. For more information on the method used for calculating the floor area of any unit, please refer to Builder Bulletin No. 22 published by Tarion. Balcony and terrace area is approximate and not included in net suite area. The actual unit purchased may be a reverse layout to the plan shown. E.&O.E.

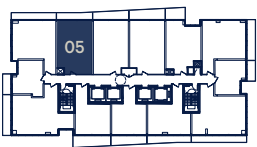
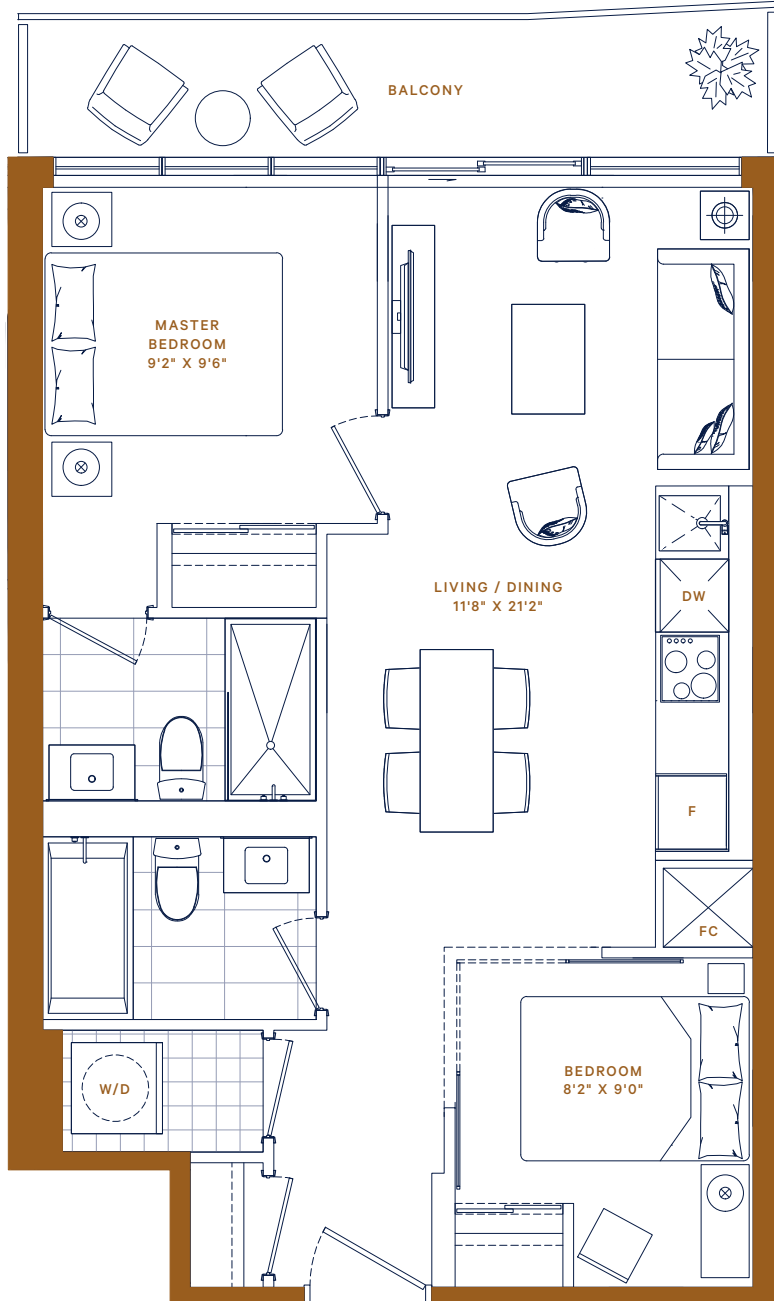

FLOORS 10-36  
BALCONY SIZES MAY VARY



Dimensions, specifications, layouts and materials are approximate only and are subject to change without notice. Window sizes and locations may vary. Furniture is for illustration purposes only and does not necessarily reflect the electrical plan for the suite. Suites are sold unfurnished. Actual useable floor space within the unit may be different from stated floor areas or dimensions on this plan. For more information on the method used for calculating the floor area of any unit, please refer to Builder Bulletin No. 22 published by Tarion. Balcony and terrace area is approximate and not included in net suite area. The actual unit purchased may be a reverse layout to the plan shown. E.&O.E.



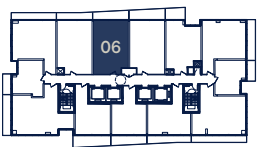
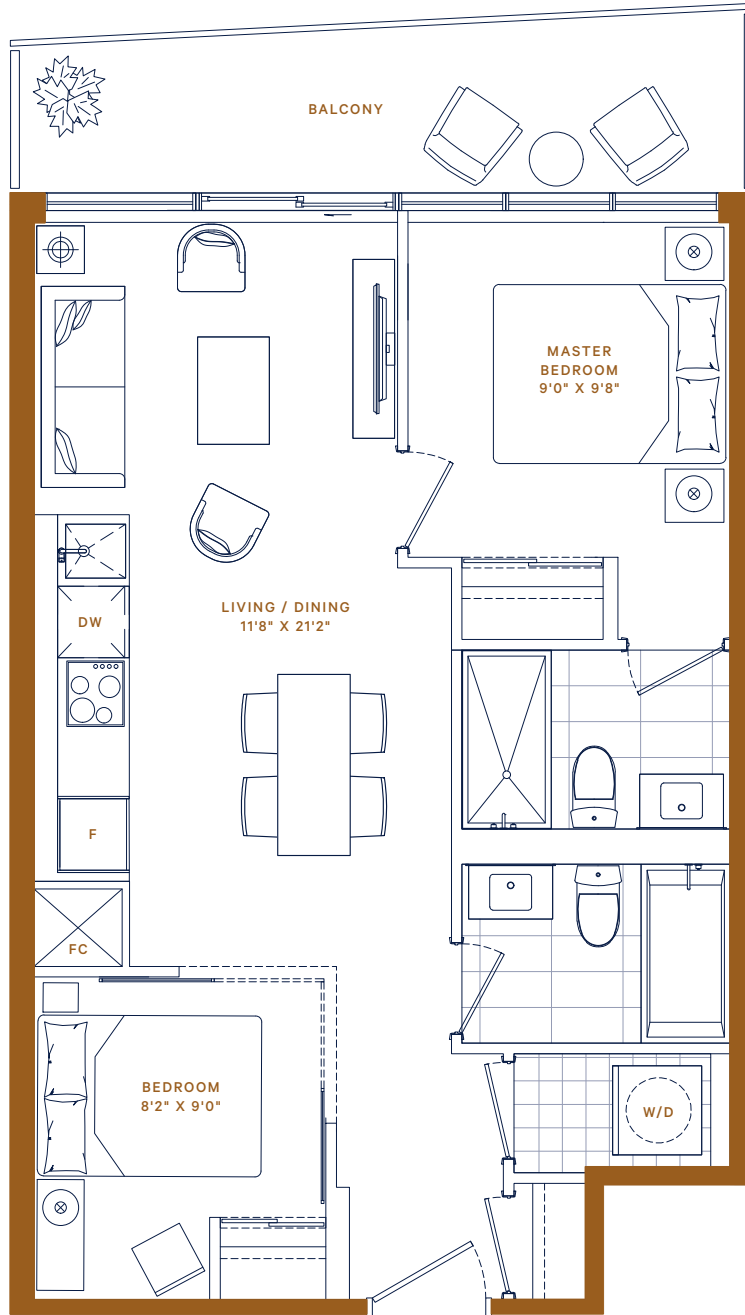

FLOORS 10-36  
BALCONY SIZES MAY VARY



Dimensions, specifications, layouts and materials are approximate only and are subject to change without notice. Window sizes and locations may vary. Furniture is for illustration purposes only and does not necessarily reflect the electrical plan for the suite. Suites are sold unfurnished. Actual useable floor space within the unit may be different from stated floor areas or dimensions on this plan. For more information on the method used for calculating the floor area of any unit, please refer to Builder Bulletin No. 22 published by Tarion. Balcony and terrace area is approximate and not included in net suite area. The actual unit purchased may be a reverse layout to the plan shown. E.&O.E.

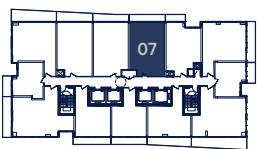
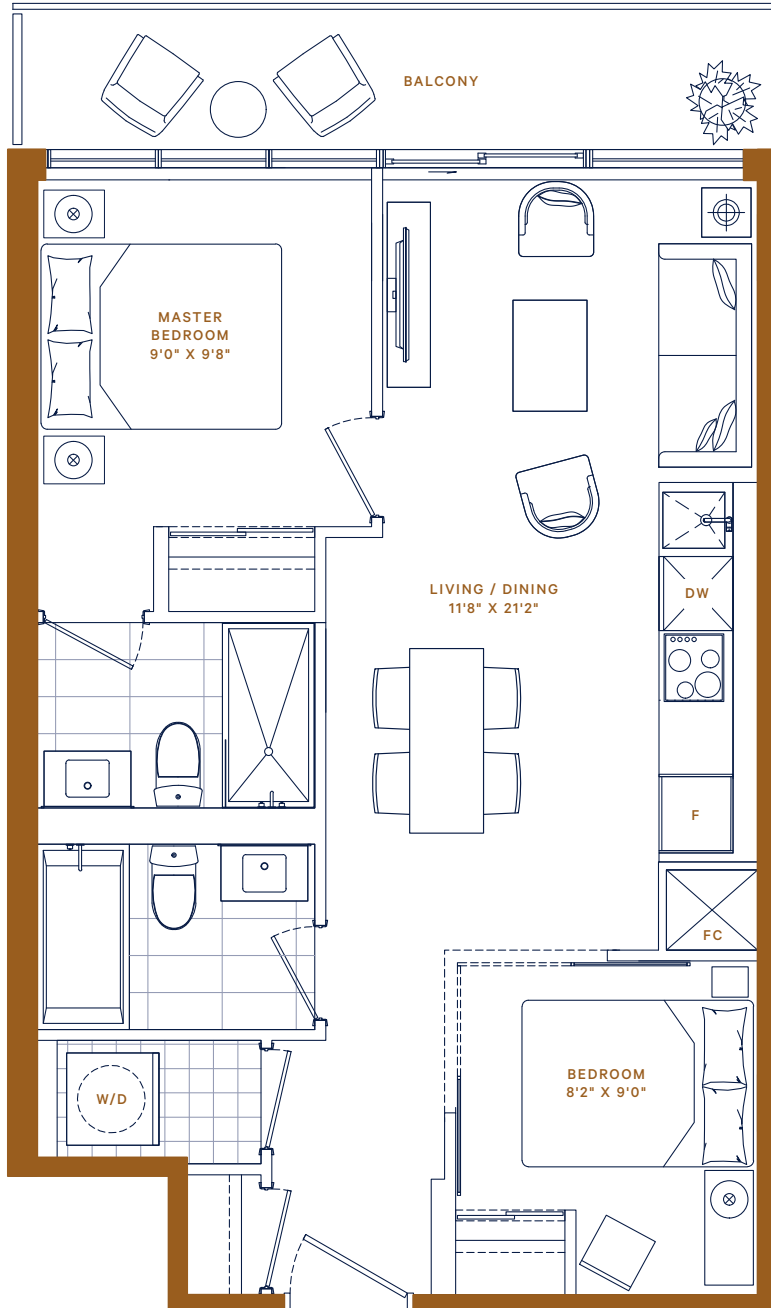

ODD FLOORS 11-35



Dimensions, specifications, layouts and materials are approximate only and are subject to change without notice. Window sizes and locations may vary. Furniture is for illustration purposes only and does not necessarily reflect the electrical plan for the suite. Suites are sold unfurnished. Actual useable floor space within the unit may be different from stated floor areas or dimensions on this plan. For more information on the method used for calculating the floor area of any unit, please refer to Builder Bulletin No. 22 published by Tarion. Balcony and terrace area is approximate and not included in net suite area. The actual unit purchased may be a reverse layout to the plan shown. E&O.E.

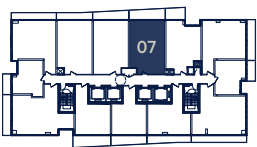
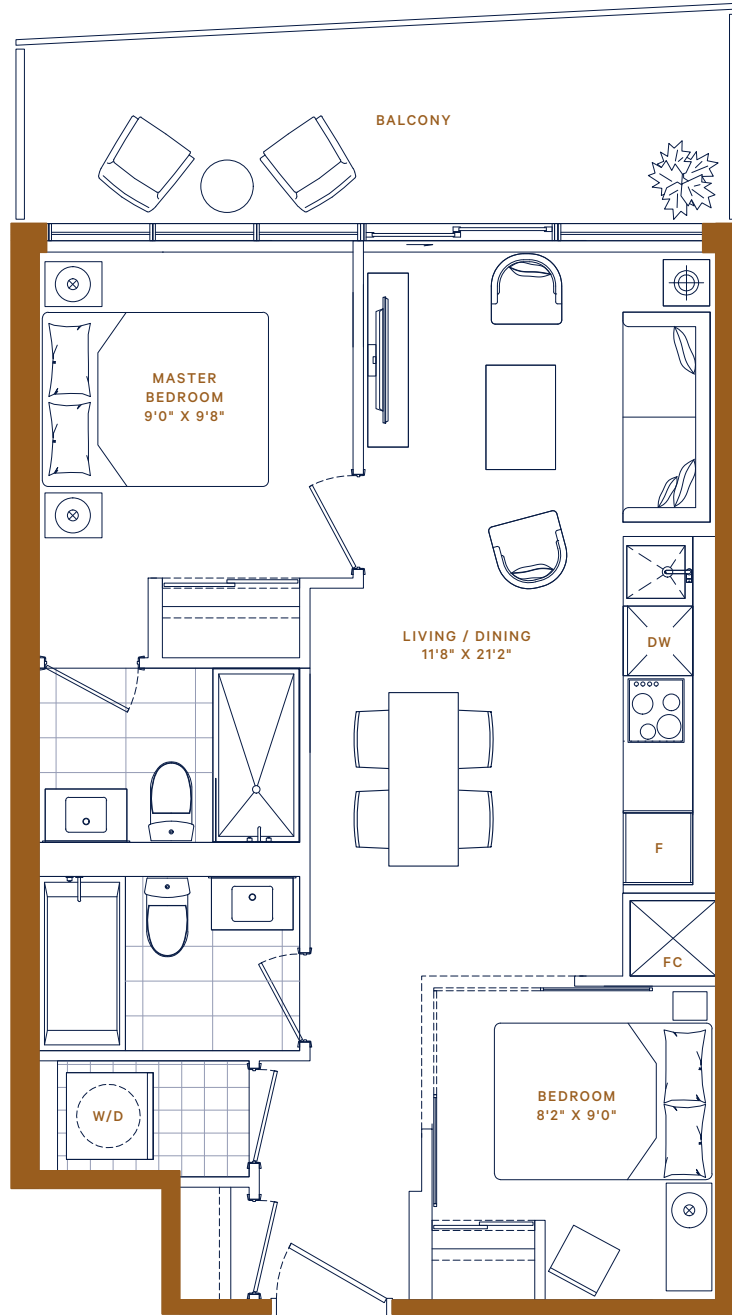

# LINE 5 | SOUTH

CONDOS AT YONGE & EGLINTON

T · 03

STUDIO

INTERIOR: 353 ft<sup>2</sup>

EXTERIOR: 55 ft<sup>2</sup>

TOTAL: 408 ft<sup>2</sup>

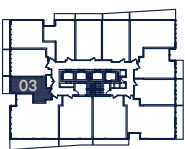
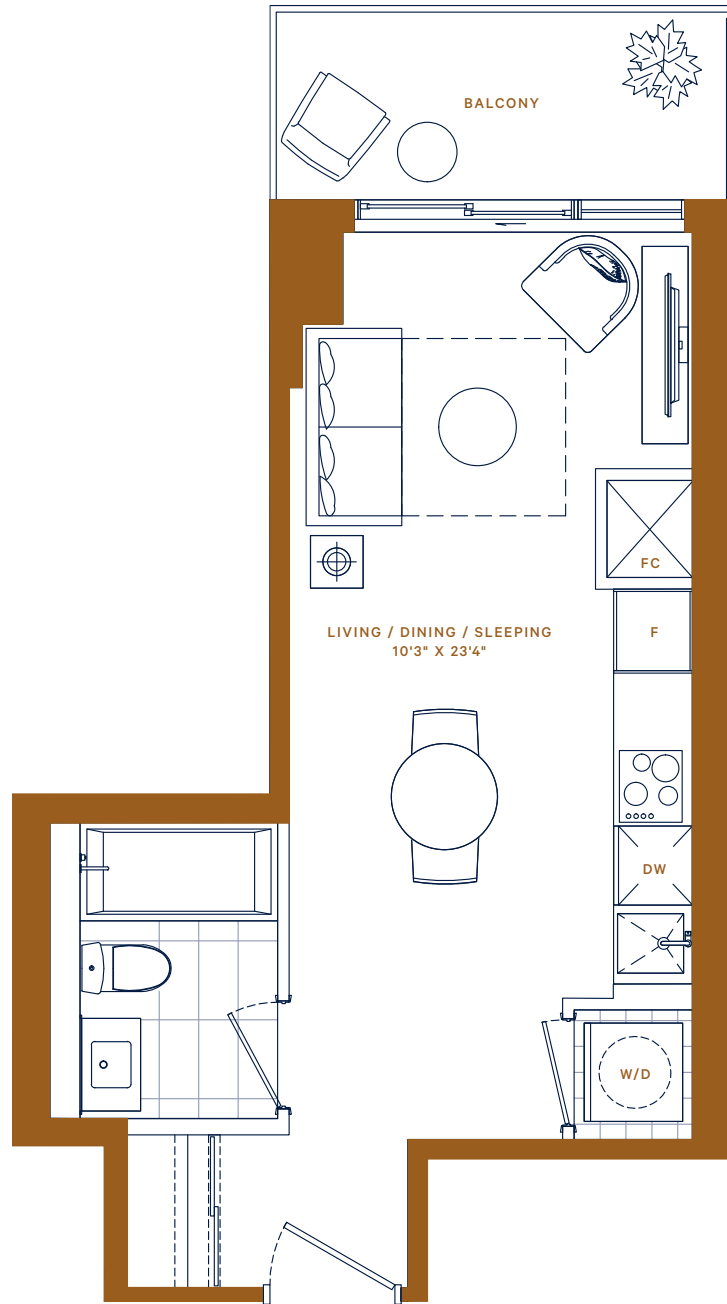

FLOORS 10-29

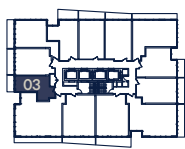

FLOORS 31-35



Dimensions, specifications, layouts and materials are approximate only and are subject to change without notice. Window sizes and locations may vary. Furniture is for illustration purposes only and does not necessarily reflect the electrical plan for the suite. Suites are sold unfurnished. Actual useable floor space within the unit may be different from stated floor areas or dimensions on this plan. For more information on the method used for calculating the floor area of any unit, please refer to Builder Bulletin No. 22 published by Tarion. Balcony and terrace area is approximate and not included in net suite area. The actual unit purchased may be a reverse layout to the plan shown. E.&O.E.



# LINE 5 | SOUTH

CONDOS AT YONGE & EGLINTON

T · 07

1 BED

INTERIOR: 482 ft<sup>2</sup>

EXTERIOR: 68 ft<sup>2</sup>

TOTAL: 550 ft<sup>2</sup>

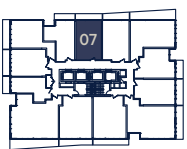
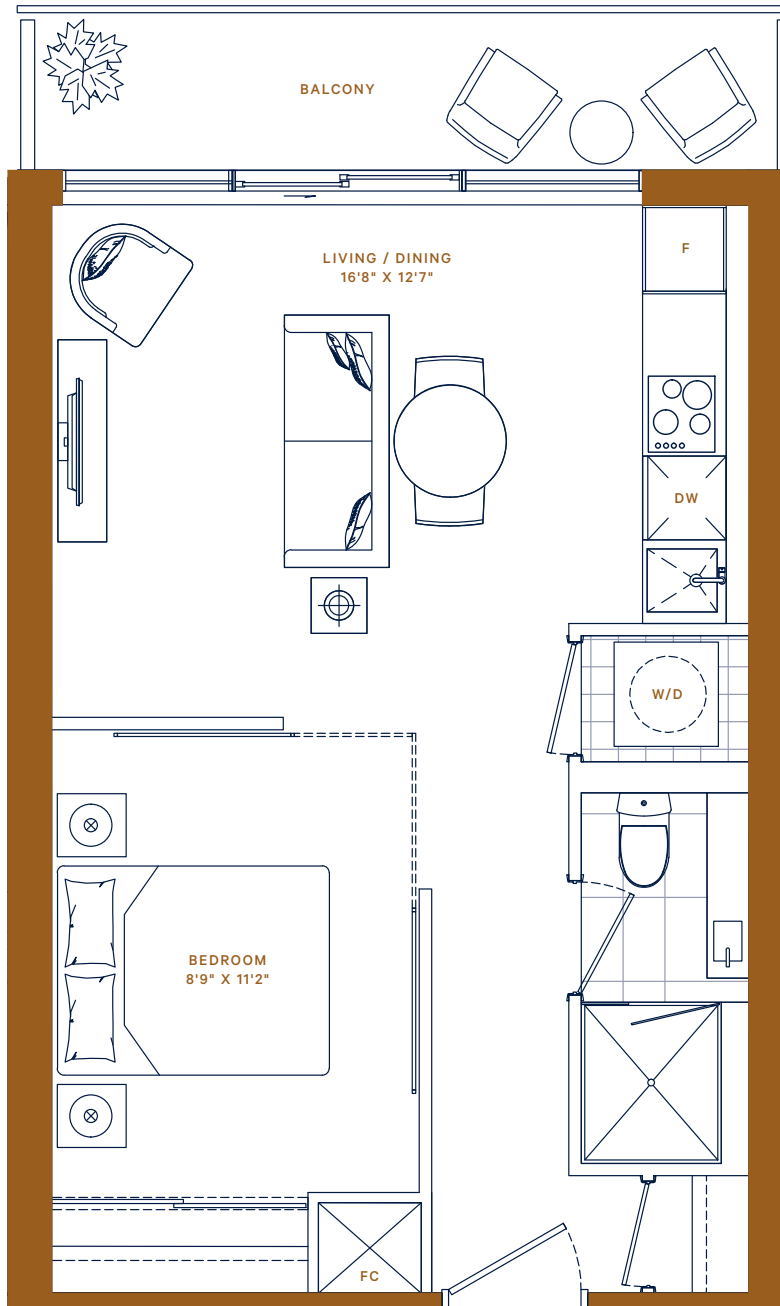

EVEN FLOORS 10-34



Dimensions, specifications, layouts and materials are approximate only and are subject to change without notice. Window sizes and locations may vary. Furniture is for illustration purposes only and does not necessarily reflect the electrical plan for the suite. Suites are sold unfurnished. Actual useable floor space within the unit may be different from stated floor areas or dimensions on this plan. For more information on the method used for calculating the floor area of any unit, please refer to Builder Bulletin No. 22 published by Tarion. Balcony and terrace area is approximate and not included in net suite area. The actual unit purchased may be a reverse layout to the plan shown. E.&O.E.

# LINE 5 | SOUTH

CONDOS AT YONGE & EGLINTON

T · 07

1 BED

INTERIOR: 482 ft<sup>2</sup>

EXTERIOR: 96 ft<sup>2</sup>

TOTAL: 578 ft<sup>2</sup>

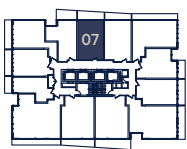
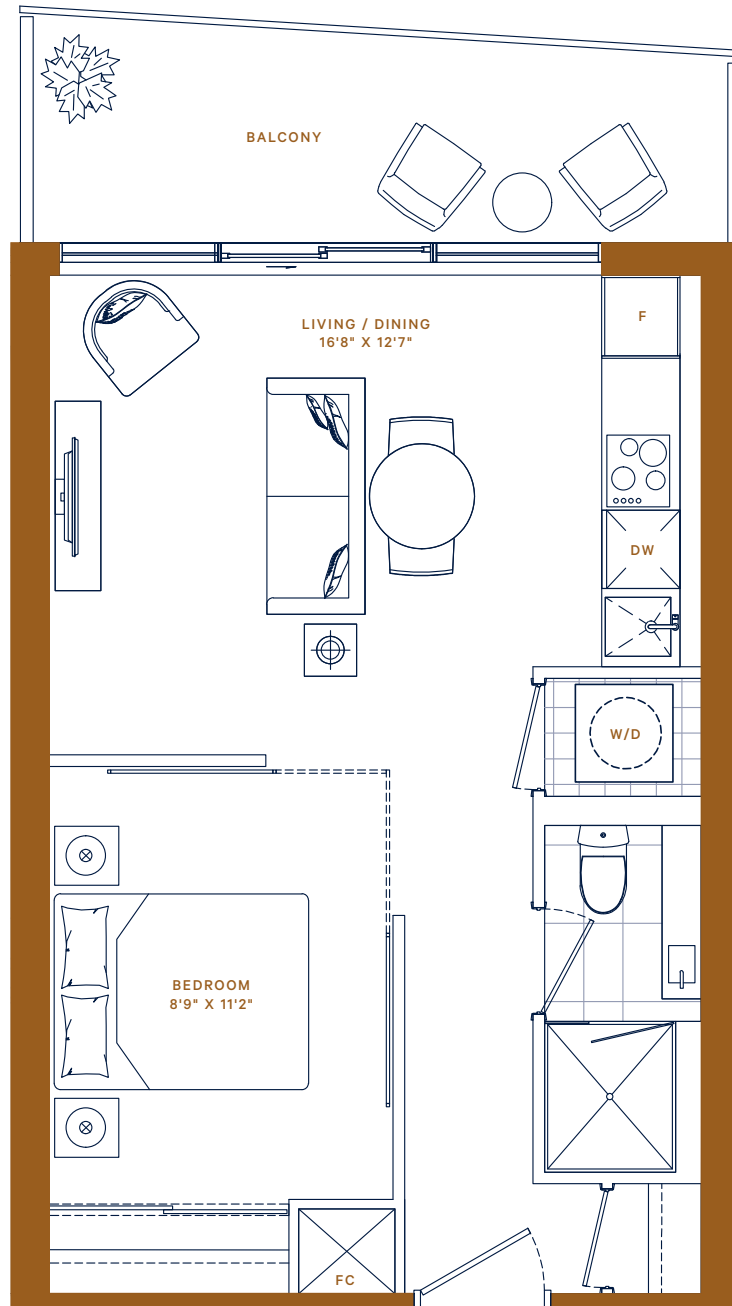

ODD FLOORS 11-35



Dimensions, specifications, layouts and materials are approximate only and are subject to change without notice. Window sizes and locations may vary. Furniture is for illustration purposes only and does not necessarily reflect the electrical plan for the suite. Suites are sold unfurnished. Actual useable floor space within the unit may be different from stated floor areas or dimensions on this plan. For more information on the method used for calculating the floor area of any unit, please refer to Builder Bulletin No. 22 published by Tarion. Balcony and terrace area is approximate and not included in net suite area. The actual unit purchased may be a reverse layout to the plan shown. E.&O.E.

[r]  
reserve  
PROPERTIES

westdale  
PROPERTIES

# LINE 5 | SOUTH

CONDOS AT YONGE & EGLINTON

**T · 08**

**1 BED + DEN**

**INTERIOR: 514 ft<sup>2</sup>**

**EXTERIOR: 76 ft<sup>2</sup>**

**TOTAL: 590 ft<sup>2</sup>**

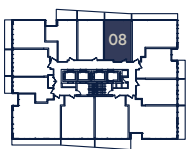
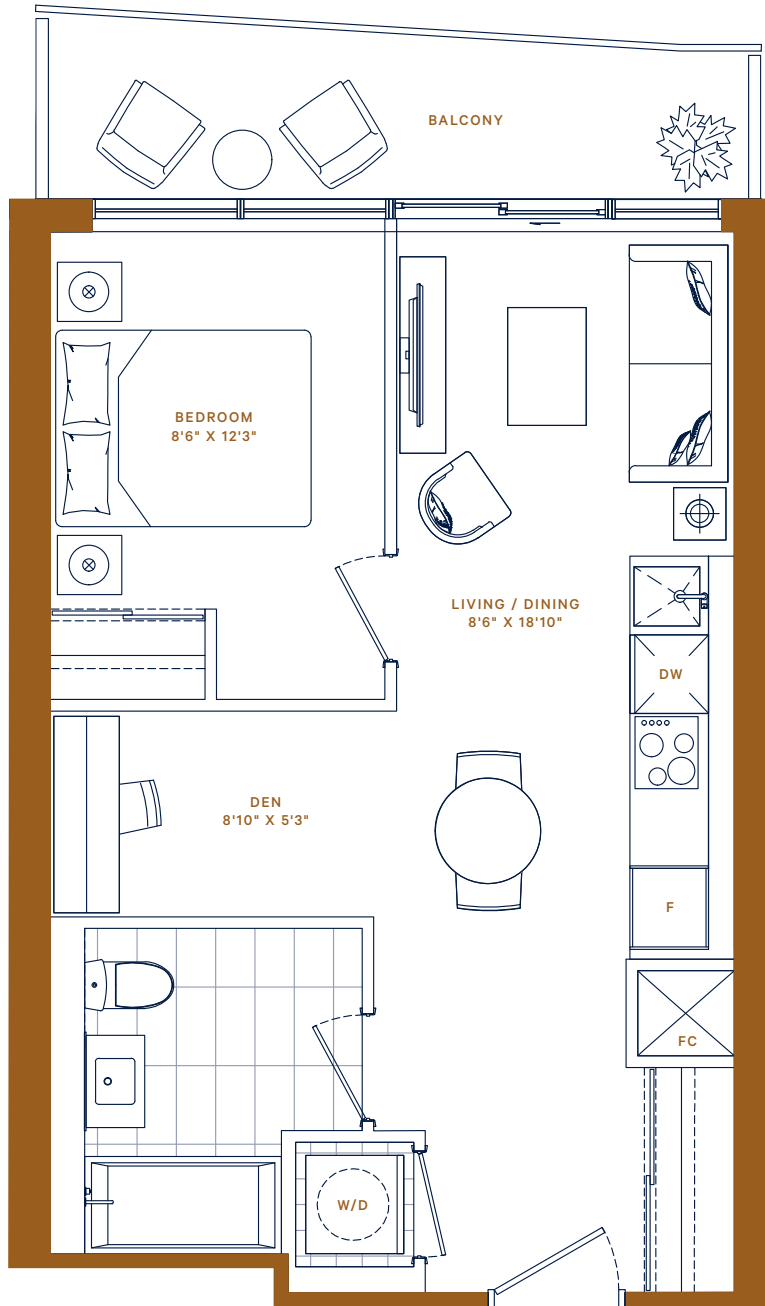

FLOORS 10-35  
BALCONY SIZES  
MAY VARY



Dimensions, specifications, layouts and materials are approximate only and are subject to change without notice. Window sizes and locations may vary. Furniture is for illustration purposes only and does not necessarily reflect the electrical plan for the suite. Suites are sold unfurnished. Actual useable floor space within the unit may be different from stated floor areas or dimensions on this plan. For more information on the method used for calculating the floor area of any unit, please refer to Builder Bulletin No. 22 published by Tarion. Balcony and terrace area is approximate and not included in net suite area. The actual unit purchased may be a reverse layout to the plan shown. E.&O.E.





CONDOS AT YONGE & EGLINTON

# WORKSHEET

<b>SUITE:</b> _____ (the Unit)  <b>MODEL:</b> _____	<b>BASE PURCHASE PRICE</b> \$ _____  <b>LOCKER COST</b> \$ _____  <b>TOTAL PURCHASE PRICE</b> \$ _____
---	--

*All Purchasers must meet the eligibility requirements set out in the Prohibition on the Purchase of Residential Property by Non-Canadians Act.*

**PLEASE FILL OUT THE FOLLOWING:**

**PURCHASER INFORMATION: PLEASE ENCLOSE CLEAR COPY OF PURCHASER PHOTO IDENTIFICATION WITH ADDRESS AND CANADIAN PASSPORT OR P.R. CARD**

PURCHASER 1		PURCHASER 2	
First Name:		First Name:	
Last Name:		Last Name:	
Address:		Address:	
Suite #:		Suite #:	
City:	Province:	City:	Province:
Postal Code:		Postal Code:	
Main Phone:		Main Phone:	
Alternate Phone:		Alternate Phone:	
Date of Birth:		Date of Birth:	
S.I.N. #		S.I.N. #	
Identification Document Type 1:	Identification Document Type 2:	Identification Document Type 1:	Identification Document Type 2:
Identification #:	Identification #:	Identification #:	Identification #:
Expiry Date:	Expiry Date:	Expiry Date:	Expiry Date:
Email:		Email:	
Profession and Company Name (for FINTRAC purposes):		Profession and Company Name (for FINTRAC purposes):	
End User or Investor?		End User or Investor?	

**Co-operating Broker: Please enclose Agent's business card.**

Name: \_\_\_\_\_

Brokerage: \_\_\_\_\_

Address: \_\_\_\_\_

Mobile: \_\_\_\_\_

Office: \_\_\_\_\_

Fax: \_\_\_\_\_

Email: \_\_\_\_\_